

Alternative Transportation Programs

Pirate BikeShare is one program we offer that allows individuals to lease a refurbished/new bicycle for an entire semester at a very low cost. Every semester our office rounds up all the abandoned bicycles left by students. After time and contact cannot be made with the owner, the bicycle becomes state property. Our department makes sure they receive all the proper repairs and maintenance and then recycles them back out to the campus community to use. Students can sign up at the Parking and Transportation Services office on Tenth Street.



Visit: www.ecu.edu/bikes

The **Bike Rental Program** is for those individuals that want to enjoy the pleasures of biking just occasionally rather than for the entire semester. This program allows riders to rent bikes by the day, the weekend, or for an entire week for a very low cost. Riders will receive a helmet, a lock, and front and rear lights. All riders can sign up for the program at Parking and Transportation Services on Tenth Street. Please check their website for current hours of operation.



LimeBike

A dock-less public bike share. LimeBike technology is integrated into smart bikes and a smart phone app. There's no kiosk docking station so bikes can be ridden anywhere and parked at any bike rack or designated bike parking area throughout campus. Download the application to find a bike, scan the QR code, then park at any bike rack when you finish your ride. For more information visit limebike.com or email limebike@ecu.edu for questions.



Ride Sharing: Zimride is a ride-sharing network that helps members of the ECU community find, post, and coordinate carpooling alternatives to individual transportation needs. Zimride is very much like Facebook. It provides a central location for finding out about member-posted ride needs and offers, and helps get individuals connected for mutually beneficial ride arrangements. Membership registration is not required. All you need to log in is your ECU Pirate ID and passphrase. This also means that you will be connecting only with members of the ECU community, giving you the most efficient and relevant ride options!

Planning to Park on Campus? You will need a Parking Permit!

New to Campus Parking?

A valid parking permit is required to park on the ECU Campus. We operate according to a lettered and numbered parking zone system to designate zone restrictions for each parking lot. Each lot will have a sign at the entrance(s), that will tell you what zone permit is restricted to that lot. Each letter associated with a zone has a number alongside of it that will indicate the different levels of access. All odd numbered zones are for faculty and staff, while the even numbered zones are for students.

We also provide Pay by Space stations for short-term parking. These stalls/spaces within these stations are numbered and must be activated at all times, even if you have a permit. If you are ever unclear as to when you can legally park in a certain lot, our office is available for clarification during normal business hours. Our website is also a wonderful resource for everything you need to know about parking on campus and more!

Visitors

Visitors to the main campus will find convenient parking in the Pay by Space stations. The Pay by Space stations are for short-term parking, while a Visitor permit **MUST** be purchased for longer visits. Visitors that have a state-issued disabled parking placard will need to let our staff know when purchasing their Visitor Permit, that they are in need of medical accommodations for proper authorization to park in the handicapped spaces on campus.



Parking and Transportation Services is pleased to provide our campus with basic bicycle maintenance and repairs every week, free of charge to the customer. We call it the **Bike Clinic** and our department gladly covers all the costs for this wonderful cause, as well as for the continuing safety of the ECU cycling community. The bike clinics are held in front of the Student Rec Center on Fridays from 10 am to 12 noon.

Bicycle Safety Tips

- 🚲 Ride with traffic and obey the same laws as motorists.
- 🚲 Always look back and use hand and arm signals to indicate your intentions to stop, merge, or turn.
- 🚲 Ride where drivers can see you.
- 🚲 Wear brightly covered clothing at all times.
- 🚲 Ride in a straight line and don't swerve between parked cars.
- 🚲 Be aware of the traffic around you and be prepared to take evasive action.
- 🚲 Learn braking and turning techniques to avoid crashes.
- 🚲 Always wear a helmet.
- 🚲 Make sure that the helmet fits on top of your head, not tipped back or forward.

The **ECU Transit System** is another great department available to students that will not only take them around campus, but around town, too. For more information, visit www.ecu.edu/transit.



Other Helpful Tips

- ✓ Make sure you are displaying your permit properly.
- ✓ Do not park in a fire lane or any other service/maintenance area.
- ✓ Do not park in a reserved space.
- ✓ Park in the appropriate zoned parking lot for the type of permit you are displaying.
- ✓ Do not park in a handicapped space without proper authorization from our office.
- ✓ Make sure your vehicle is properly registered in our system.
- ✓ If you lock your keys in your car or need a jumpstart while on campus property, then call our office. We're here to help... **FREE** of charge!



www.ecu.edu/parking

Parking Deck Opening Late 2018

Construction is underway to build the new Student Union and Parking Deck on main campus. We're excited to be able to bring ECU its first parking deck! The projected completion date is set for 2018. Once completed, the deck will hold approximately 700 parking spaces.

As ECU grows each year and until the parking deck is open, we ask for everyone's understanding of the very limited parking available on main campus. As a result, parking on main campus is not guaranteed.

(artist rendering of ECU Parking Deck)

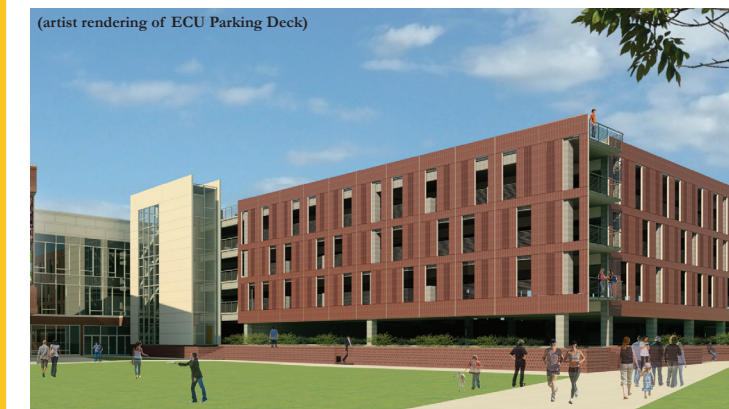

Parking & Transportation Services

305 East 10th Street • East Carolina University • Greenville, NC 27858-4353
252-328-6294 • www.ecu.edu/parking

HEALTH SCIENCES CAMPUS

West Research Campus

Medical Pavilion

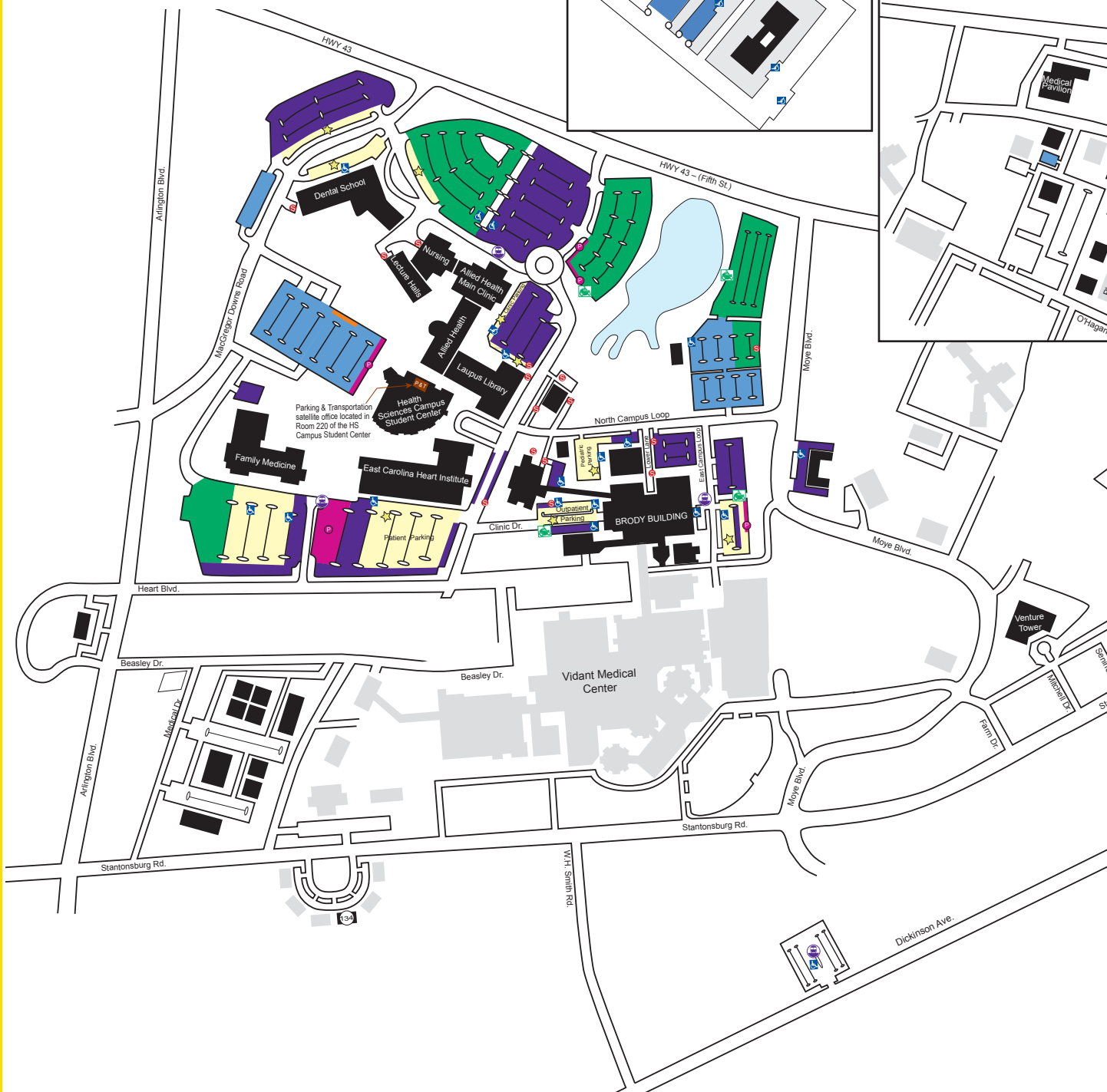

PARKING ZONES

Subject to minor changes due to construction or other reasons. Check signs carefully before parking. Check parking permit for valid zones.

STAFF ZONES

- ZONE A1** Main Campus Faculty/Staff (interchangeable with A3)
- ZONE A3** Health Sciences Campus Faculty/Staff (interchangeable with A1)
- ZONE B1** Main Campus Faculty/Staff (interchangeable with B3)
- ZONE B3** Health Sciences Campus and West Research Faculty/Staff (interchangeable with B1)

STUDENT ZONES

- ZONE A2** College Hill Resident Students
- ZONE B2** West End Resident Students
- ZONE B4** Health Sciences Commuter Students
- ZONE C2** C2 Athletic Campus/South Campus Commuter Parking
- ZONE D** Resident Students

OTHER ZONES

- MOTORCYCLE
- STATE VEHICLES
- ECU TRANSIT STOP
- PARKING AND TRANSPORTATION OFFICE
- METERED/PAY SPACE
- DISABILITY ACCESS
- CONSTRUCTION ZONE
- PATIENT PARKING (Patients need to call office for authorization)
- VISITOR PARKING (Permit Required)

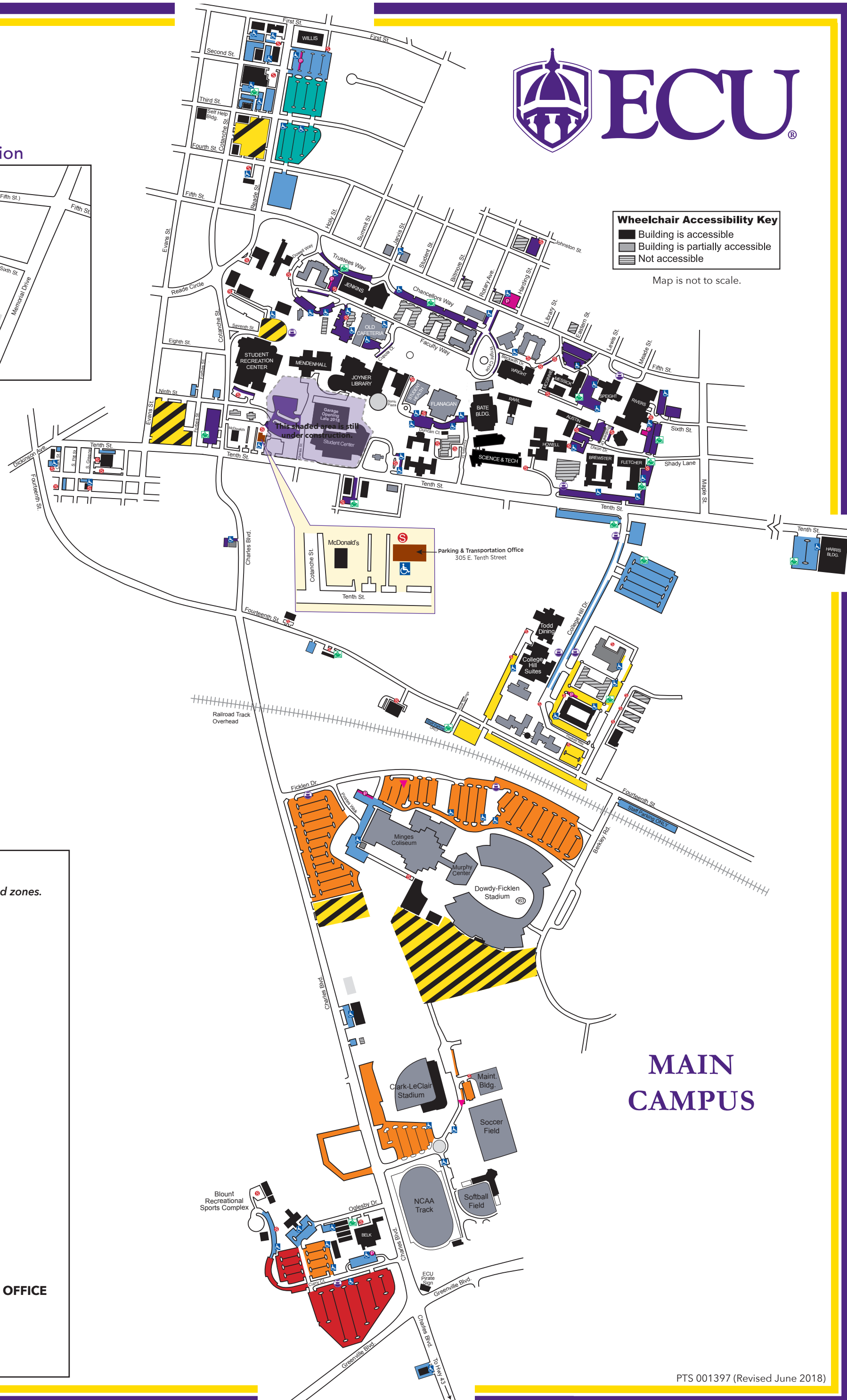

Wheelchair Accessibility Key

- Building is accessible
- Building is partially accessible
- Not accessible

Map is not to scale.

MAIN CAMPUS